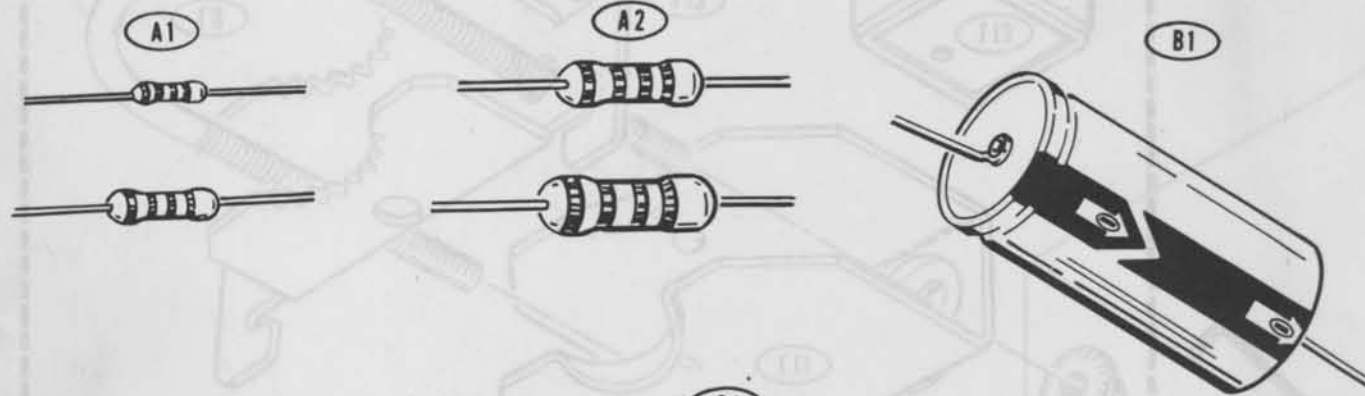

ILLUSTRATION BOOKLET

Part of 595-2279-01

PARTS PICTORIAL

John Ewing
10909 Ewing
888 8567



NOTE: HEATH PART NUMBERS ARE STAMPED ON MOST DIODES.

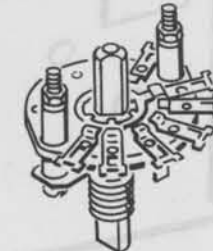
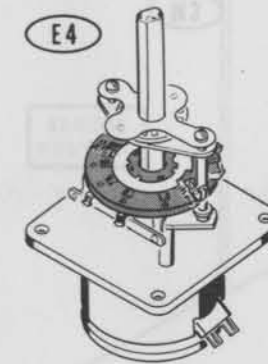
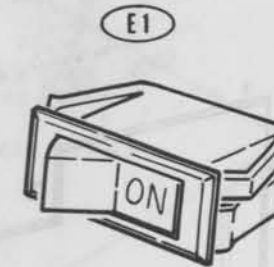
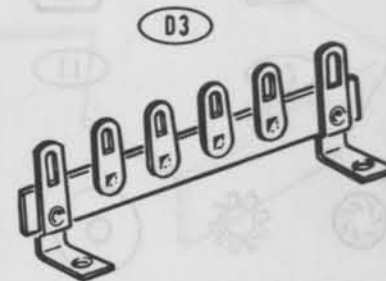
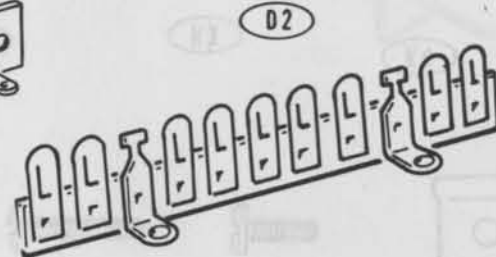
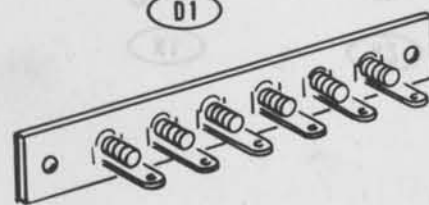
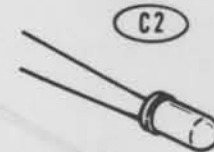
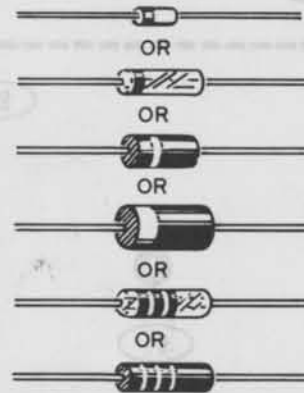

OR

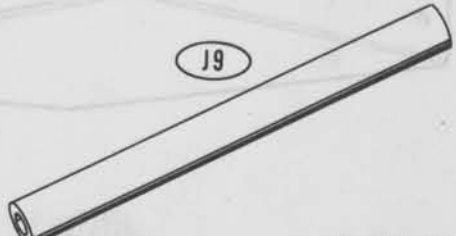
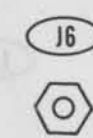
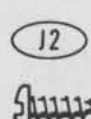
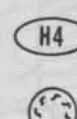
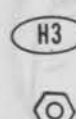
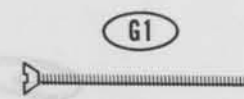
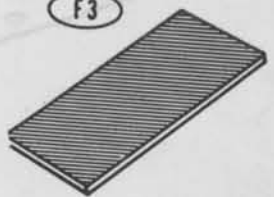
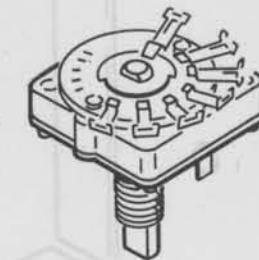

Copyright © 1979
Heath Company
All Rights Reserved
Printed in the United States of America

Model SA-1480

Parts Pictorial (Cont'd.)

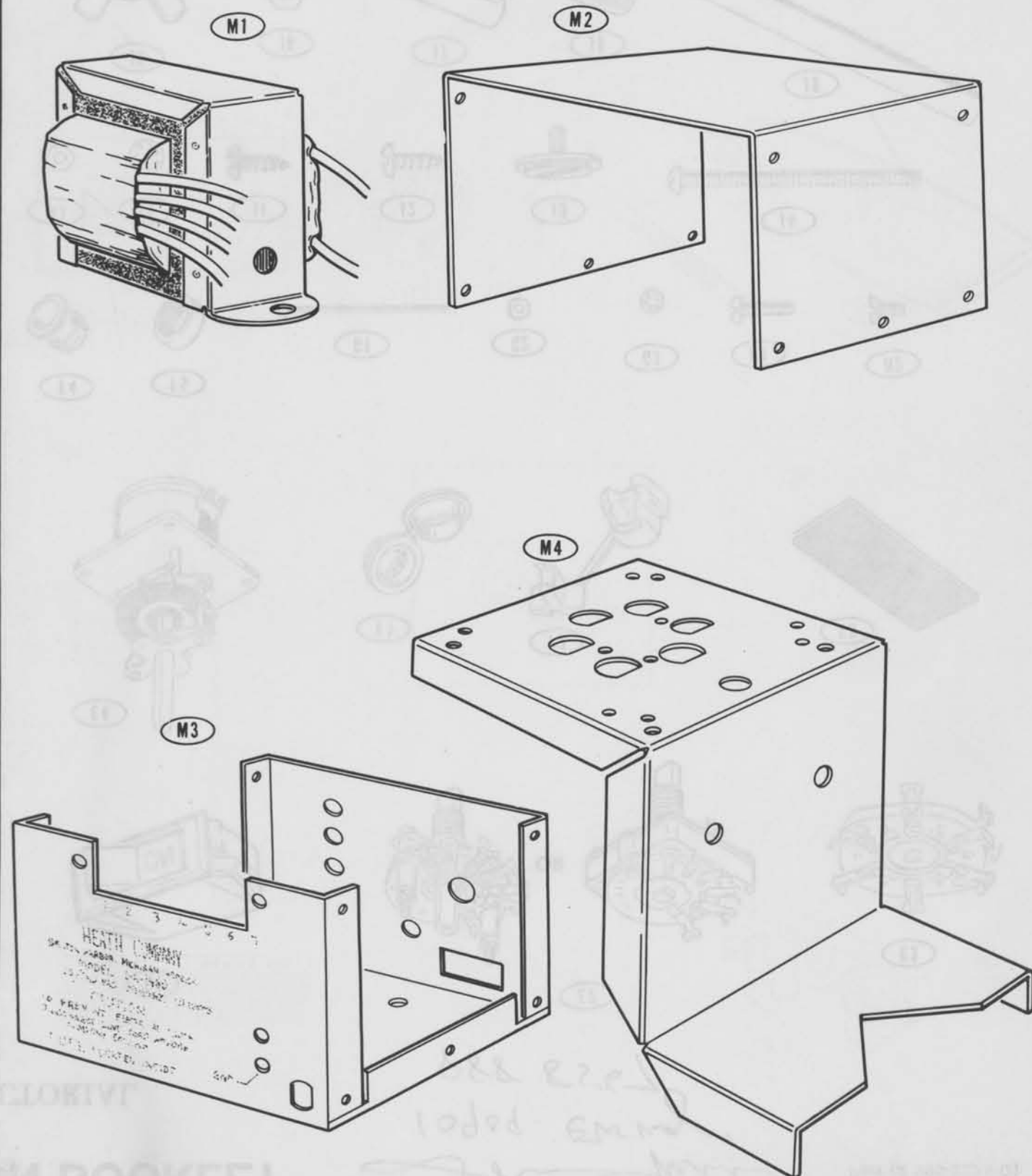
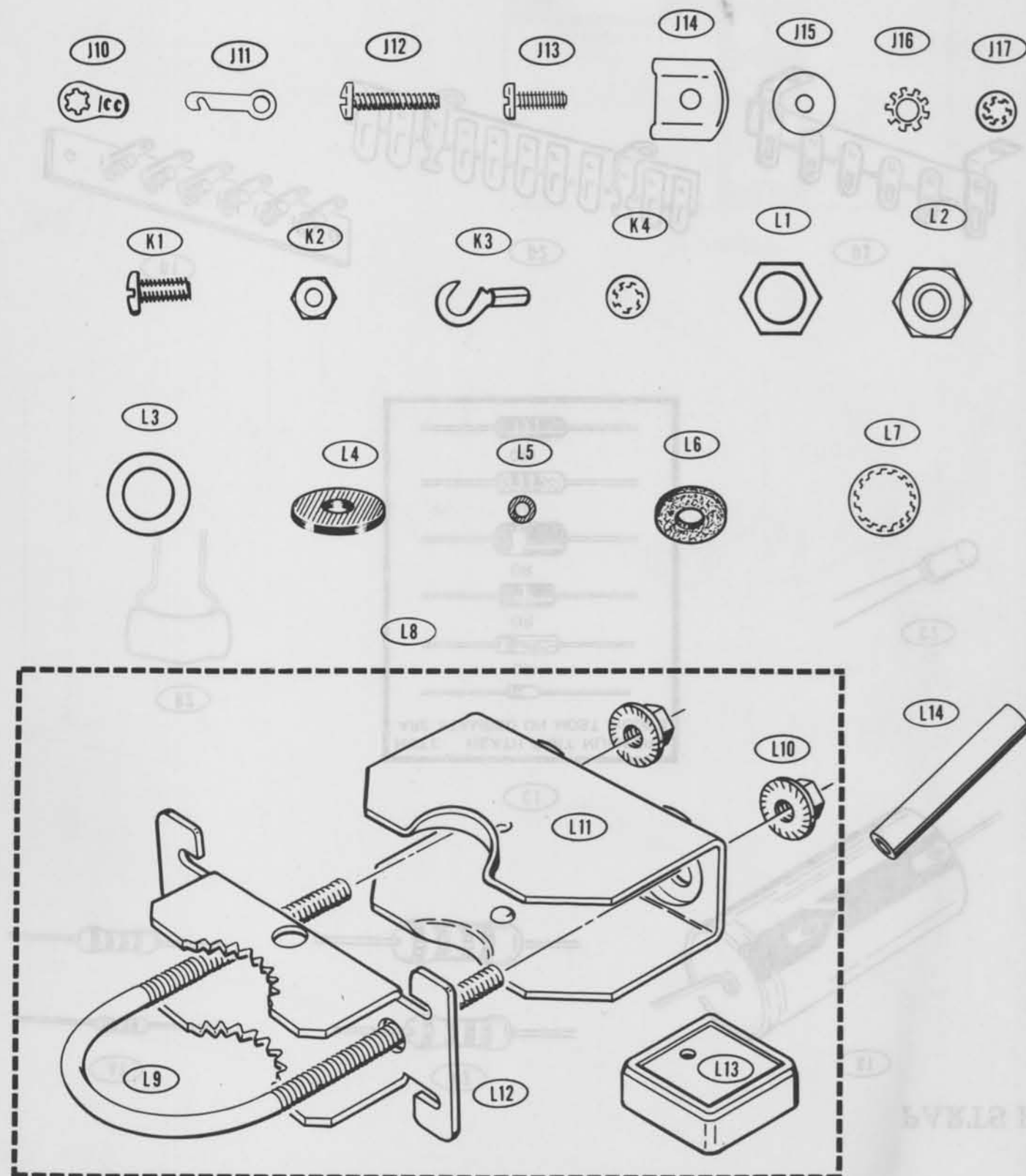

Parts Pictorial (Cont'd.)

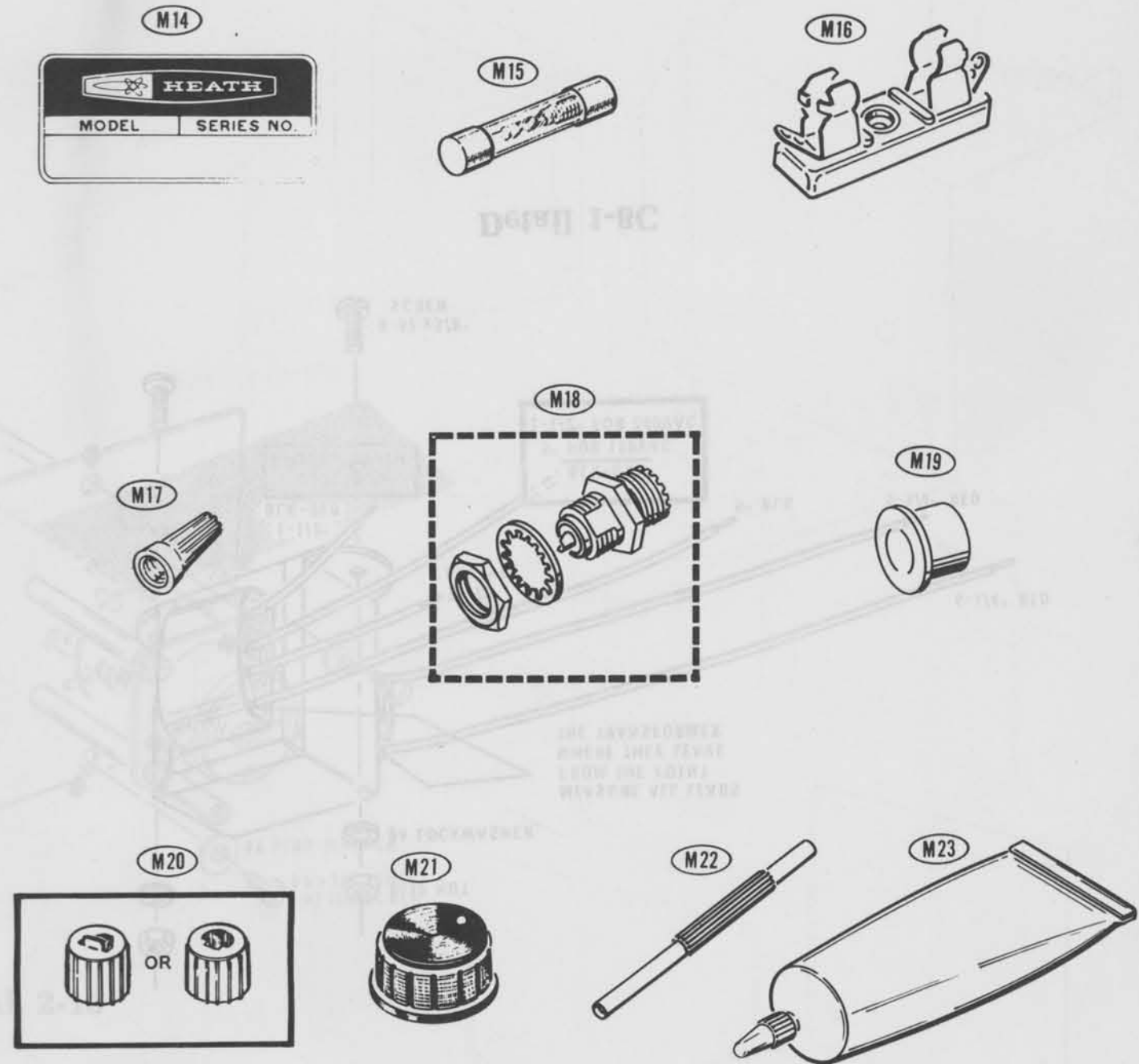
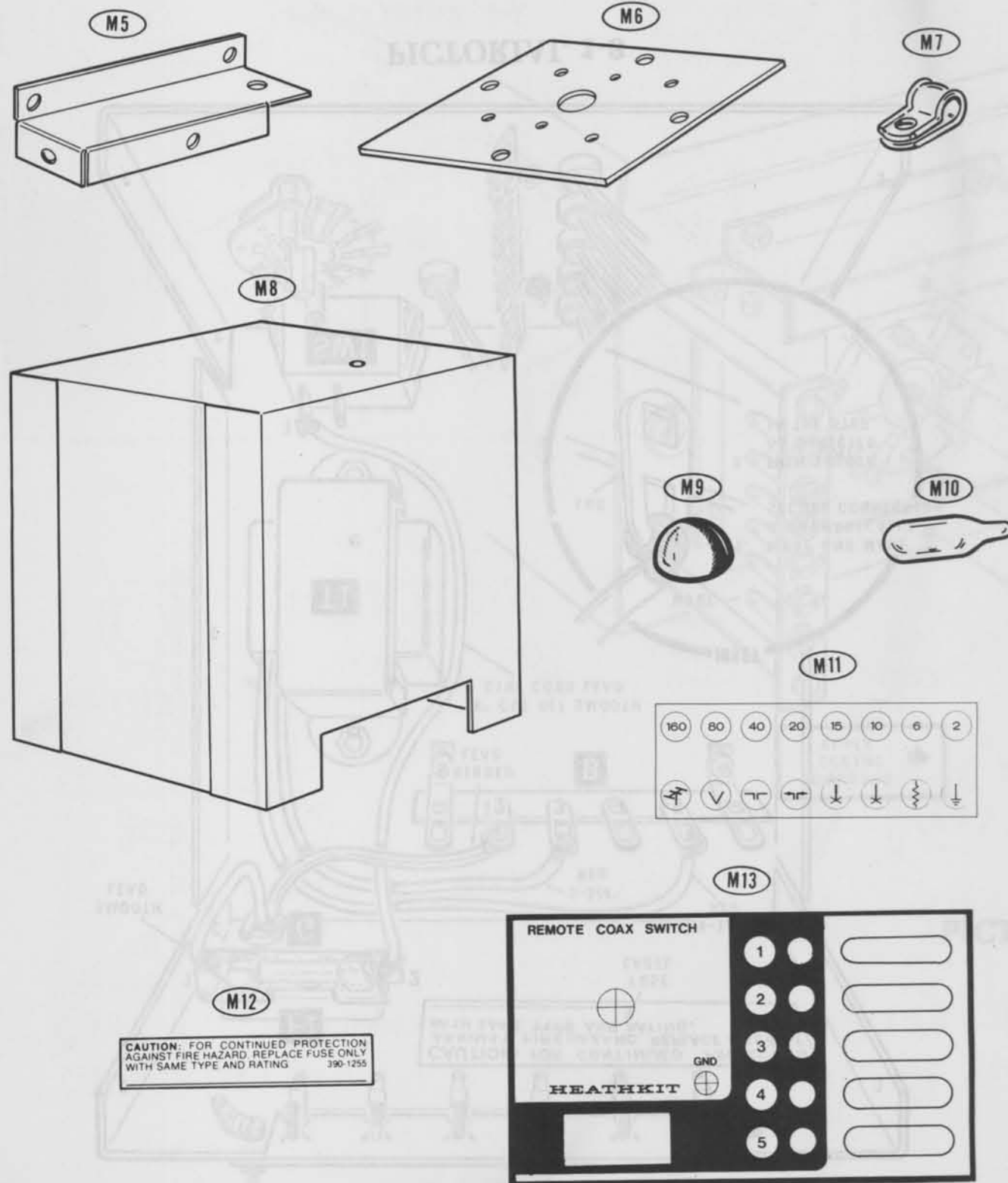

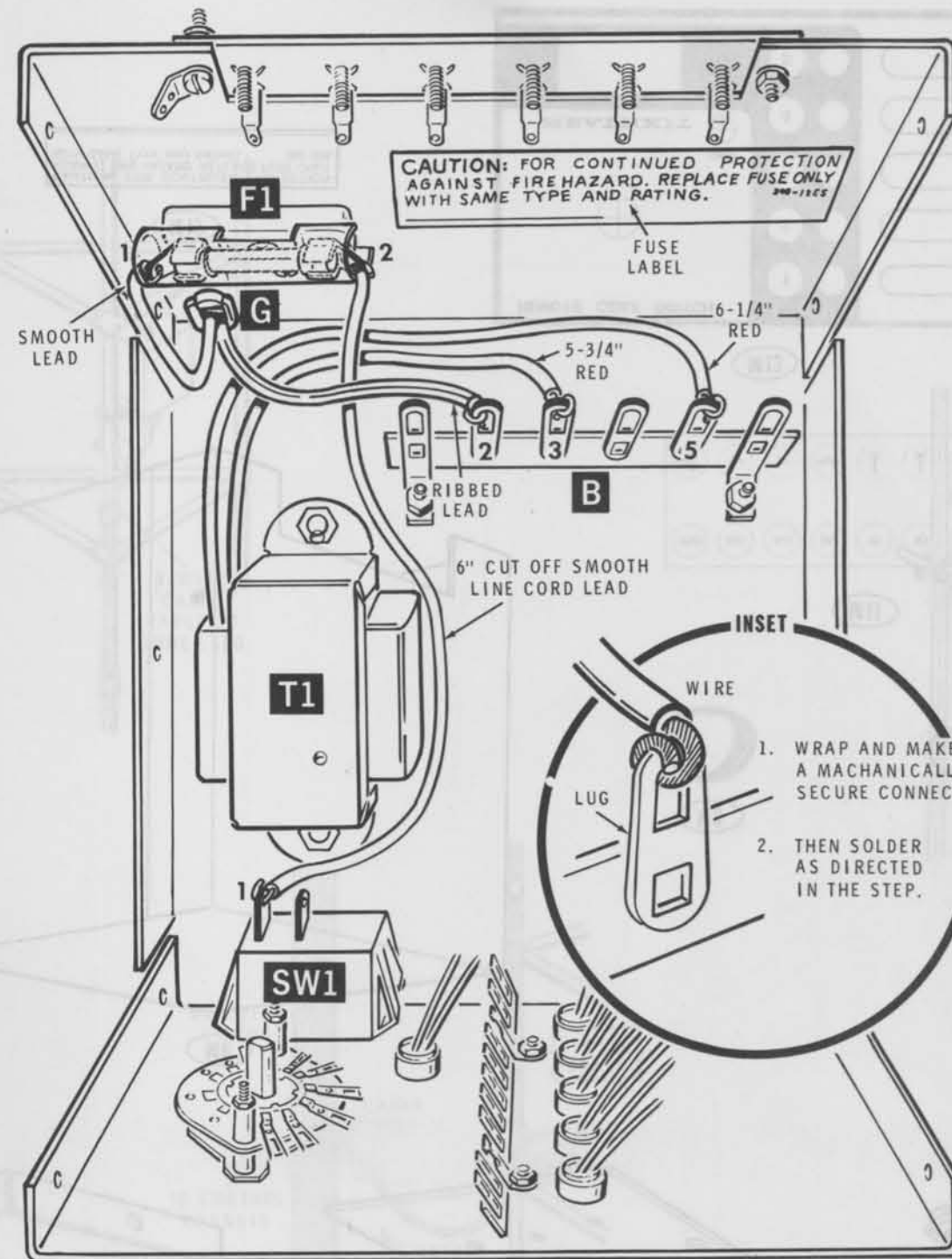

PICTORIAL 1-8

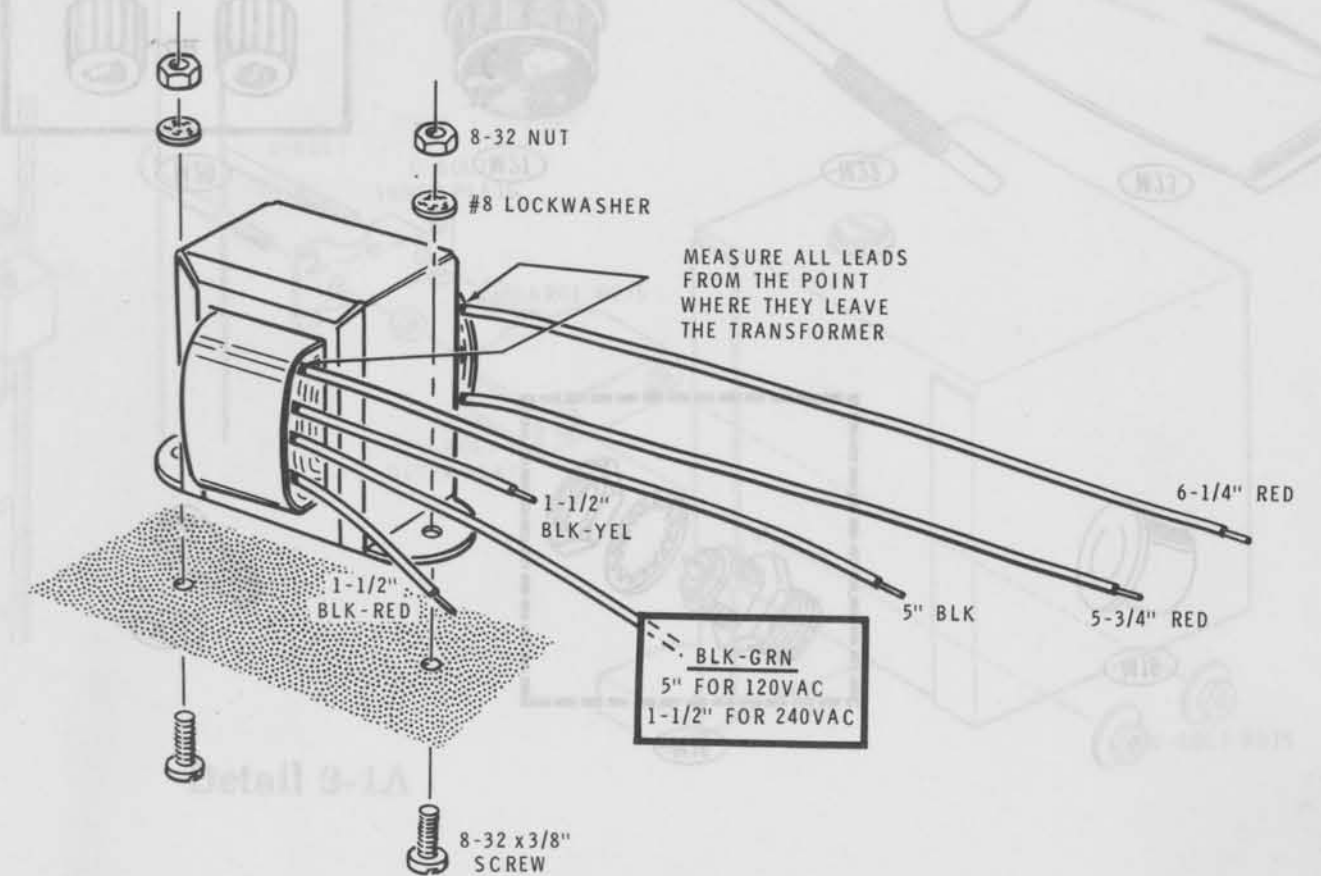

Detail 1-8C

NOTE: THE KNOB INSERT MAY LOOK LIKE EITHER A OR B BELOW IT MUST GO ON THE SHAFT AS SHOWN.

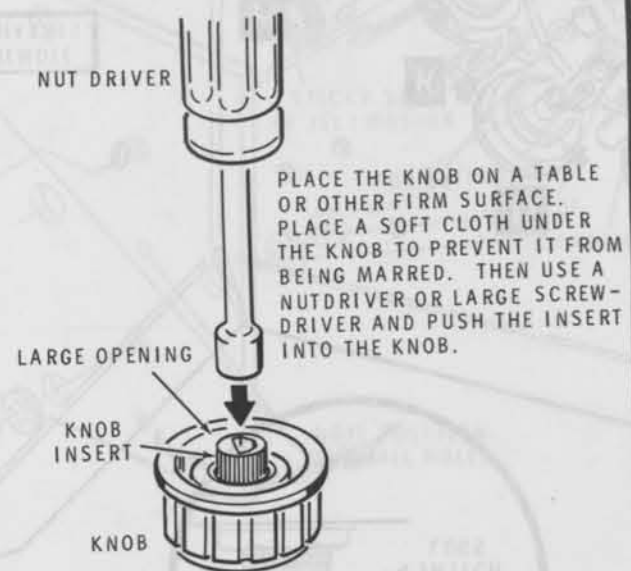
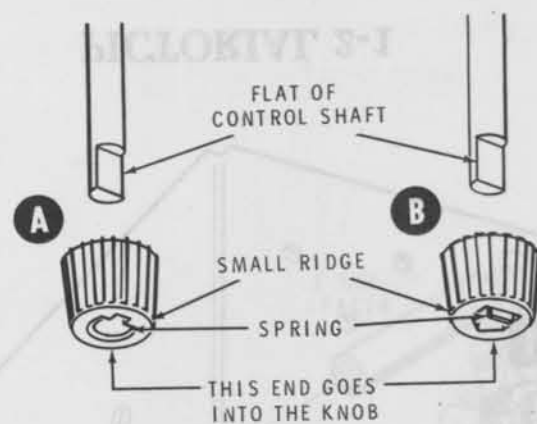

PICTORIAL 1-10

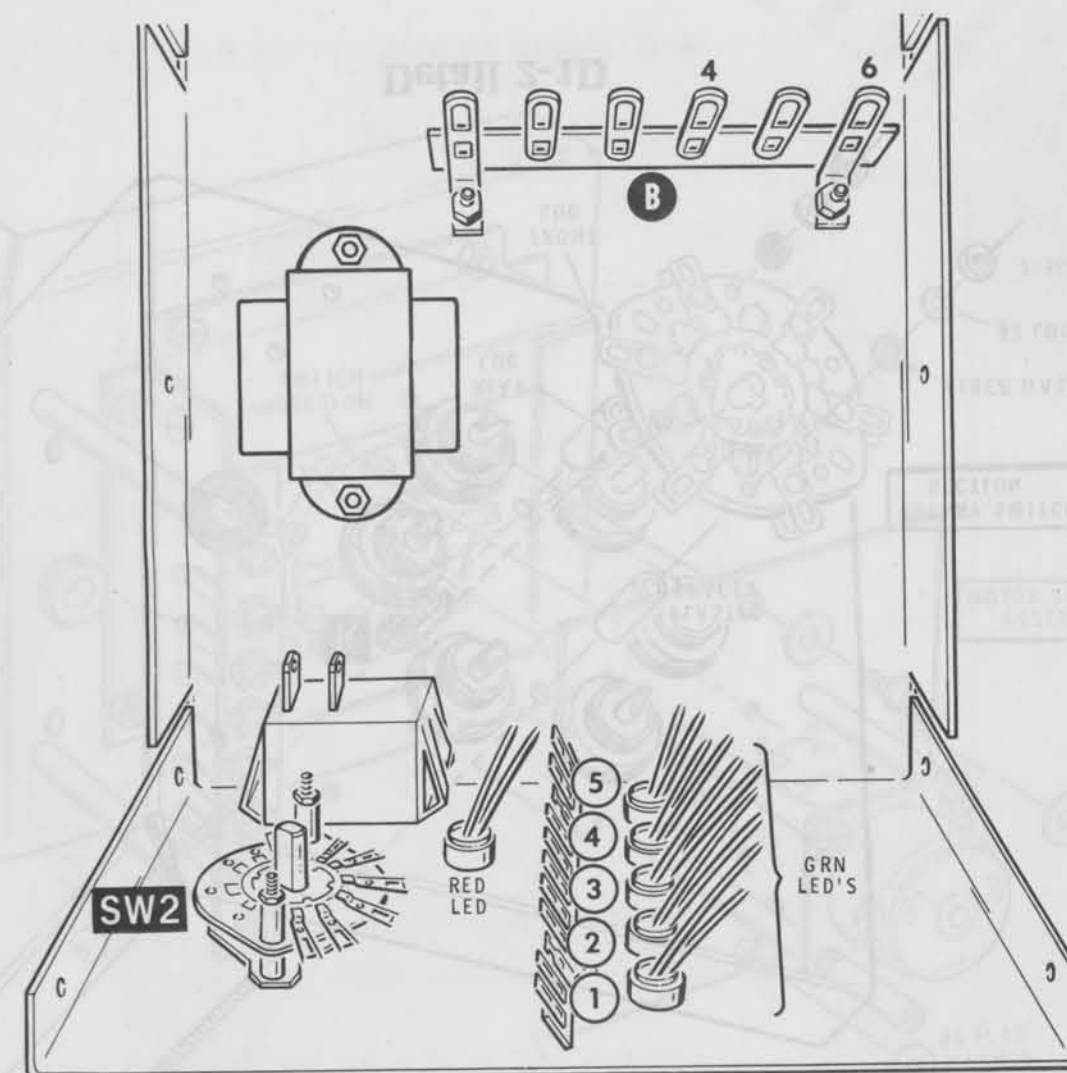

PICTORIAL 1-11

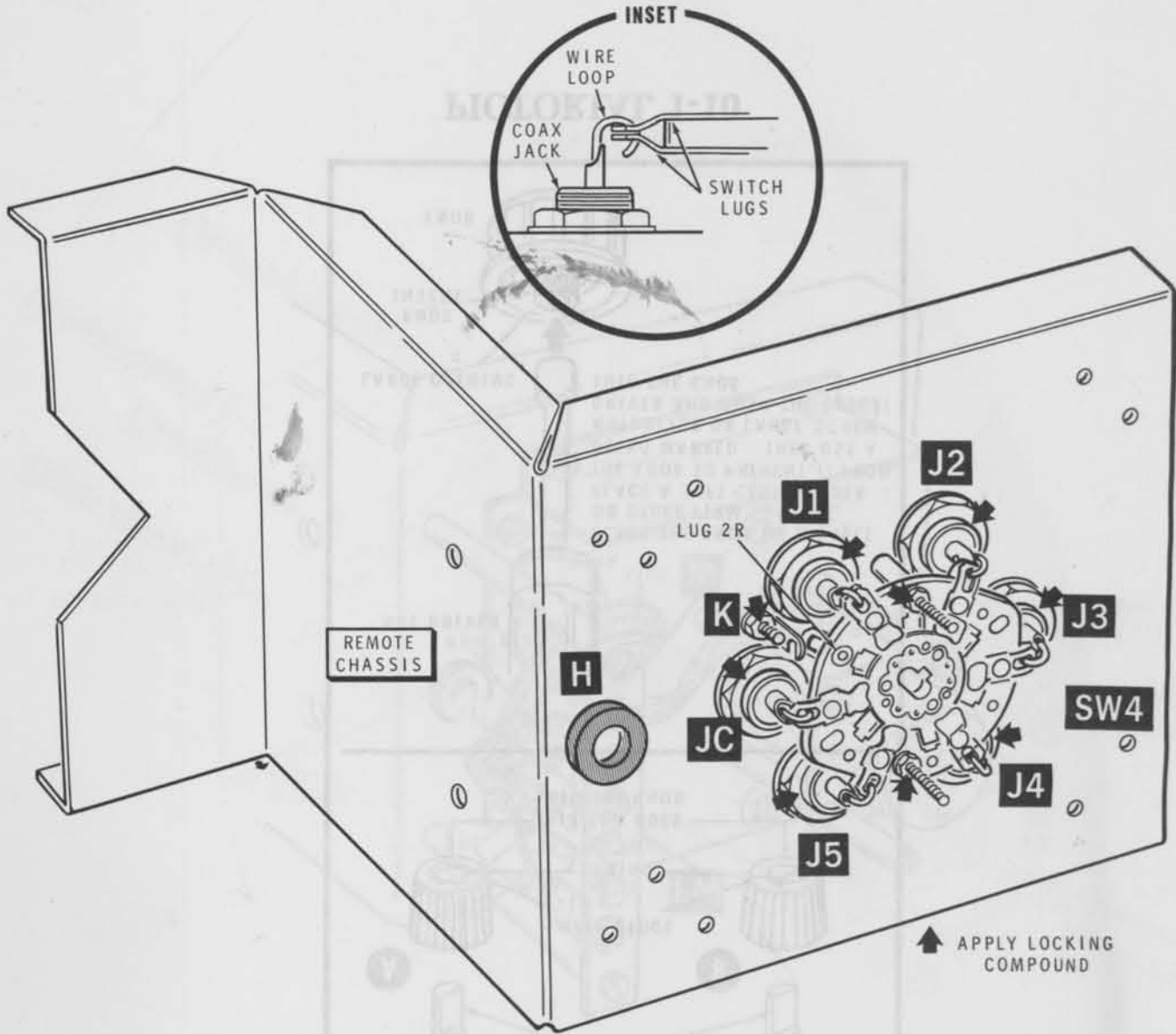

PICTORIAL 2-1

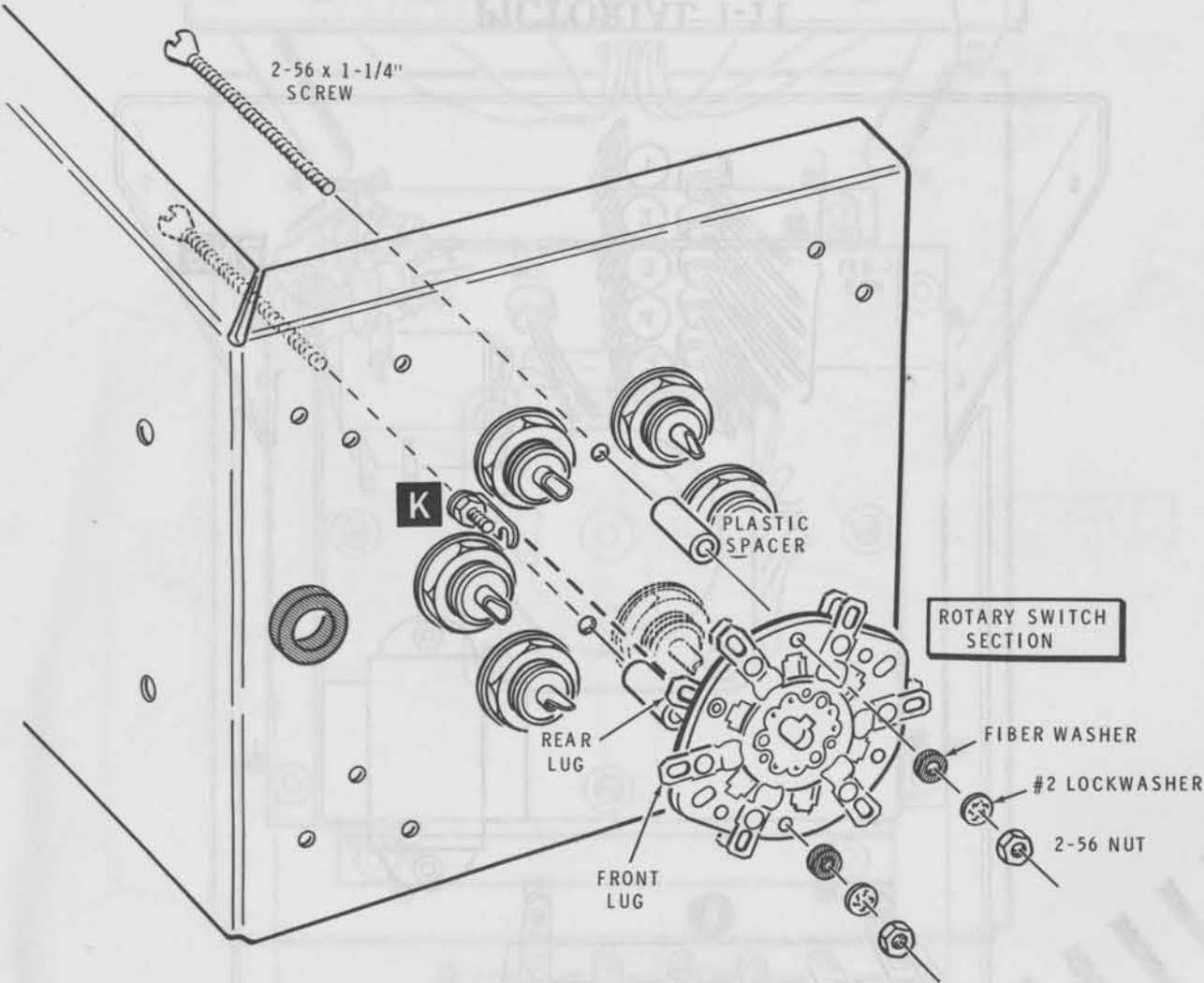

Detail 2-1D

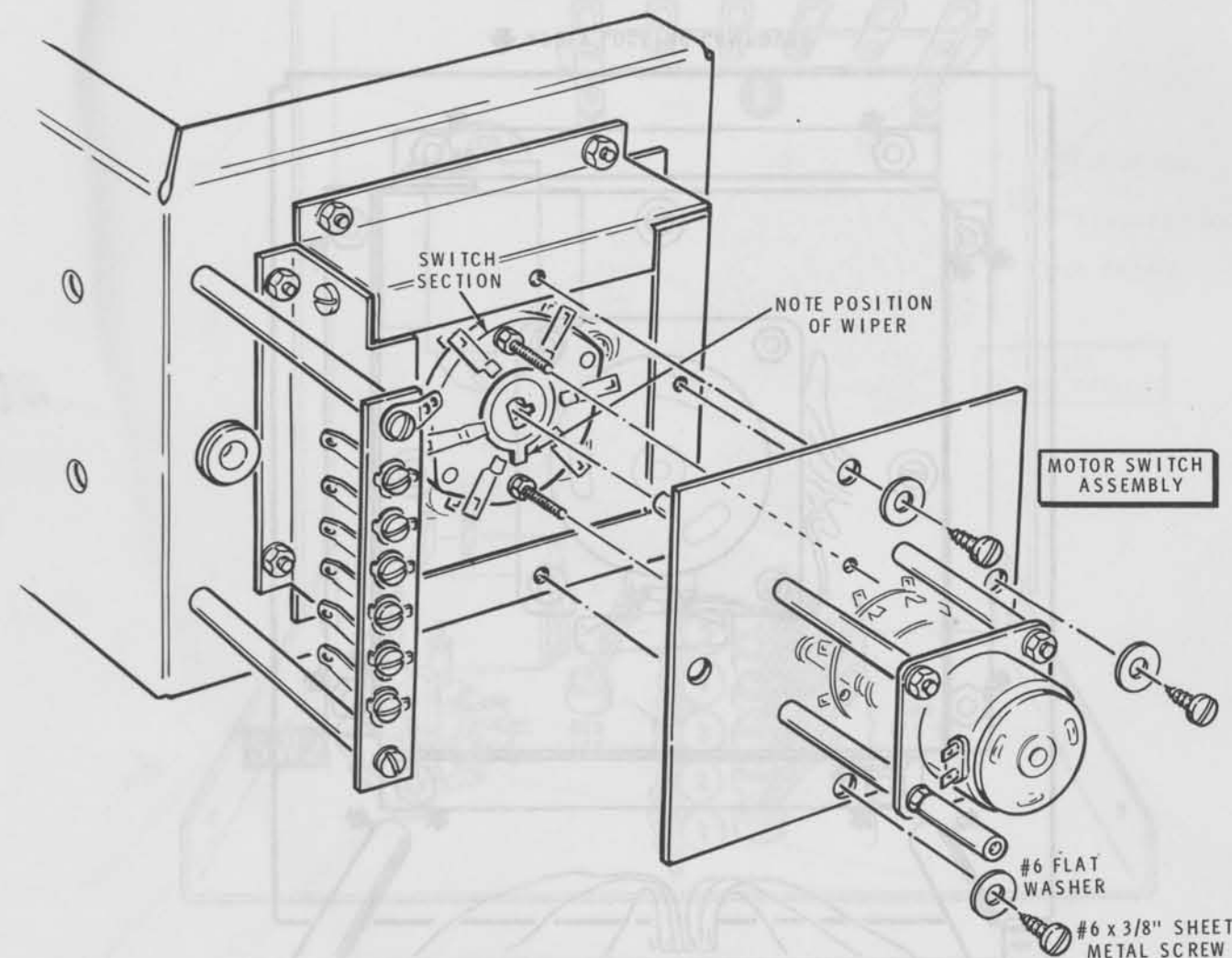
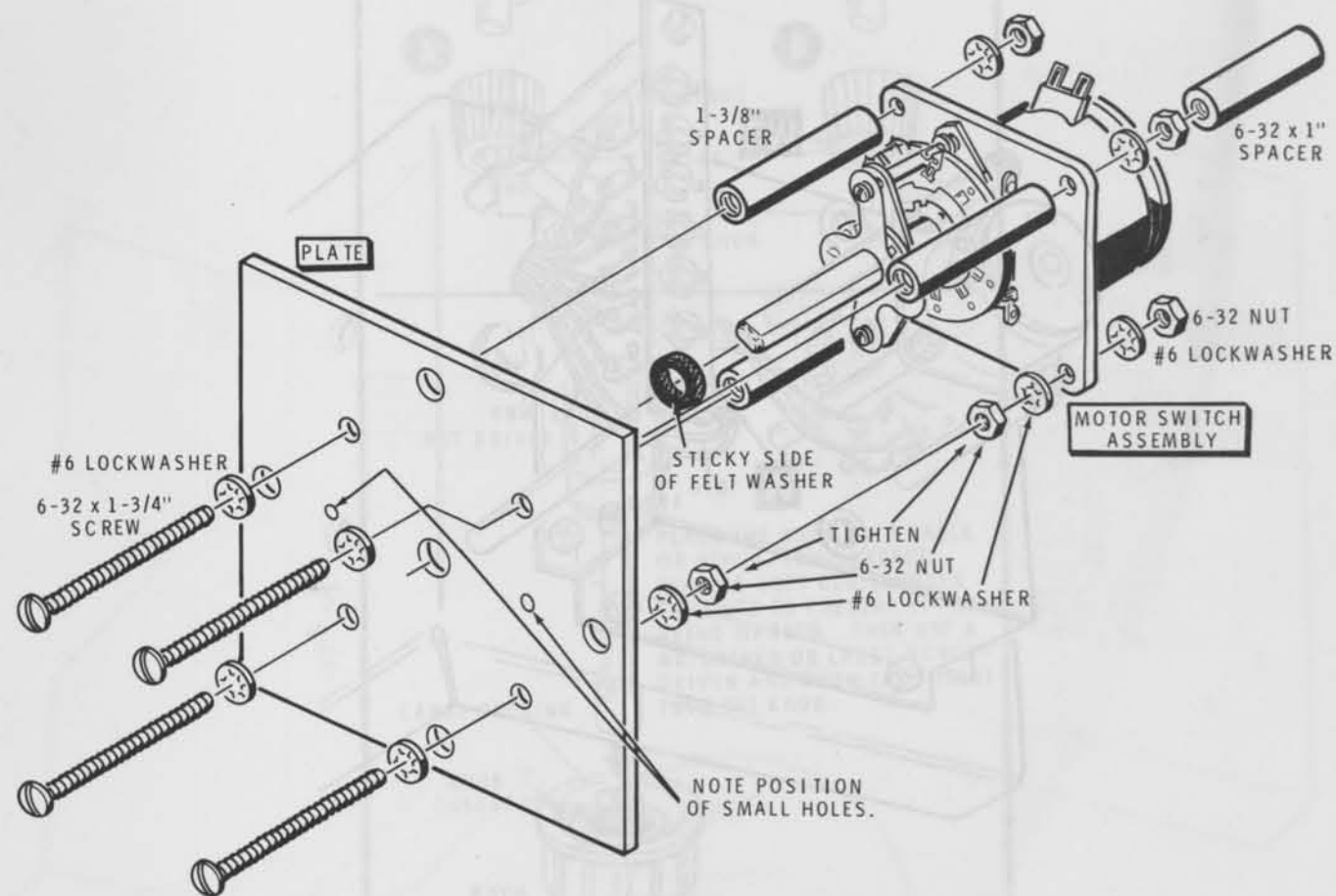

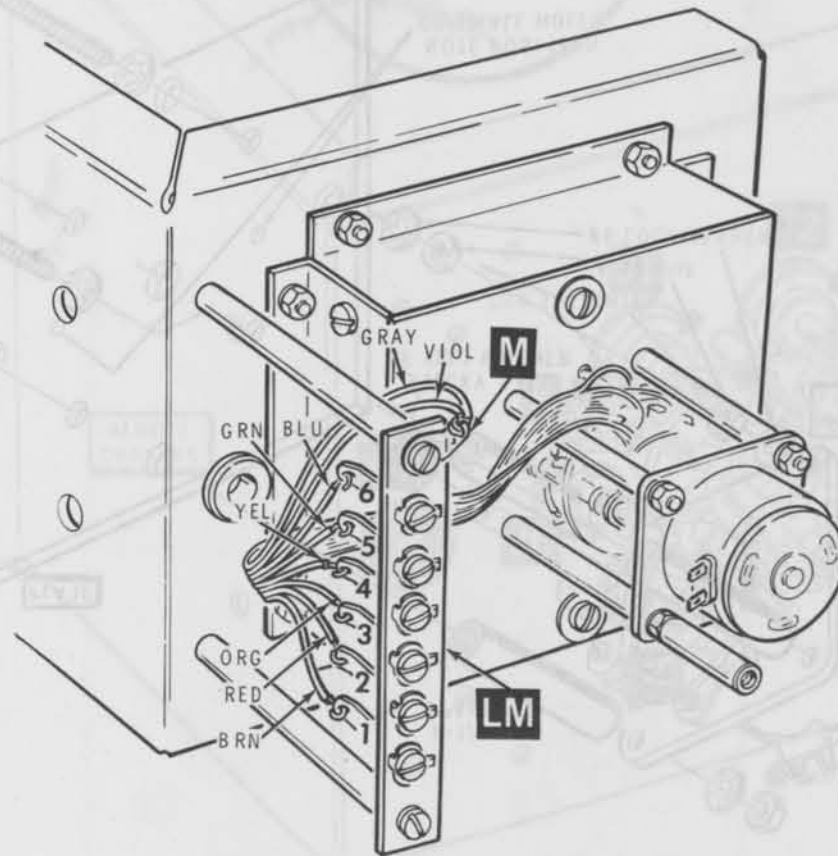

PICTORIAL 2-6

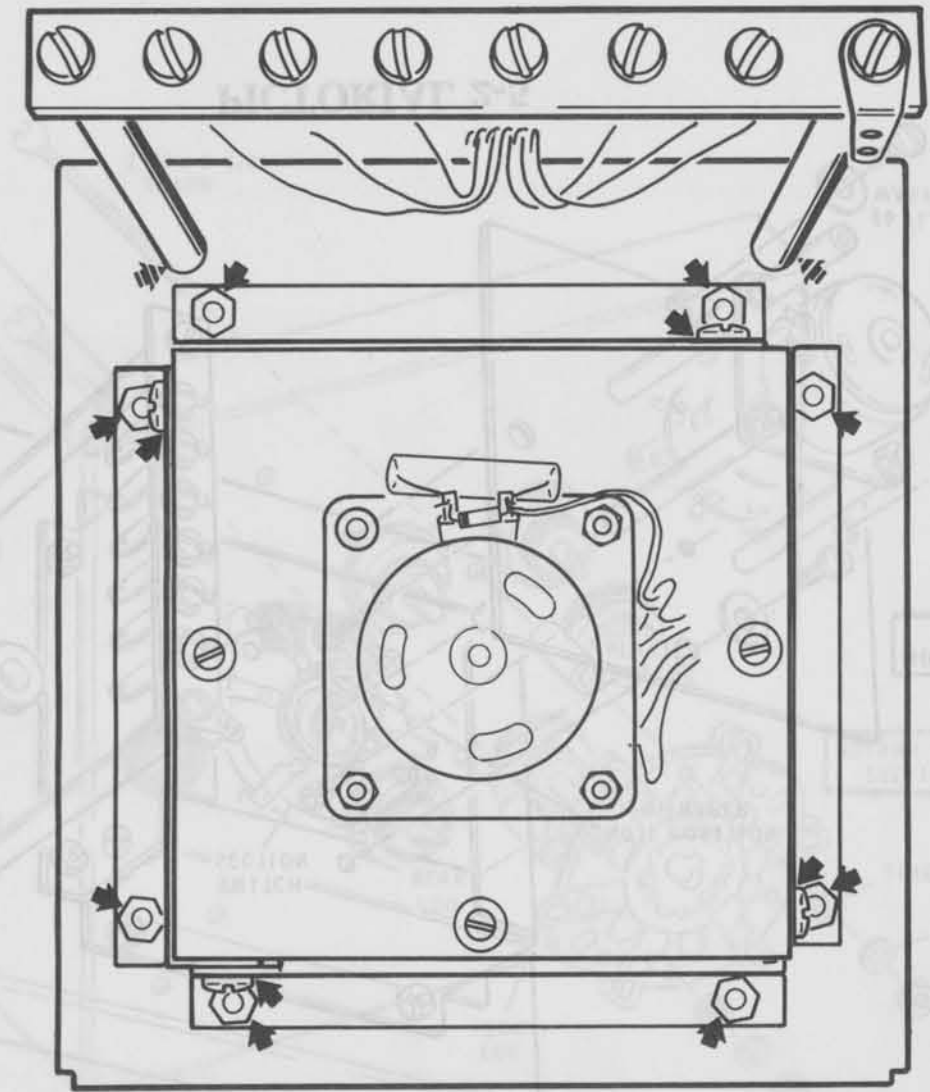

▲ APPLY LOCKING COMPOUND

PICTORIAL 2-9

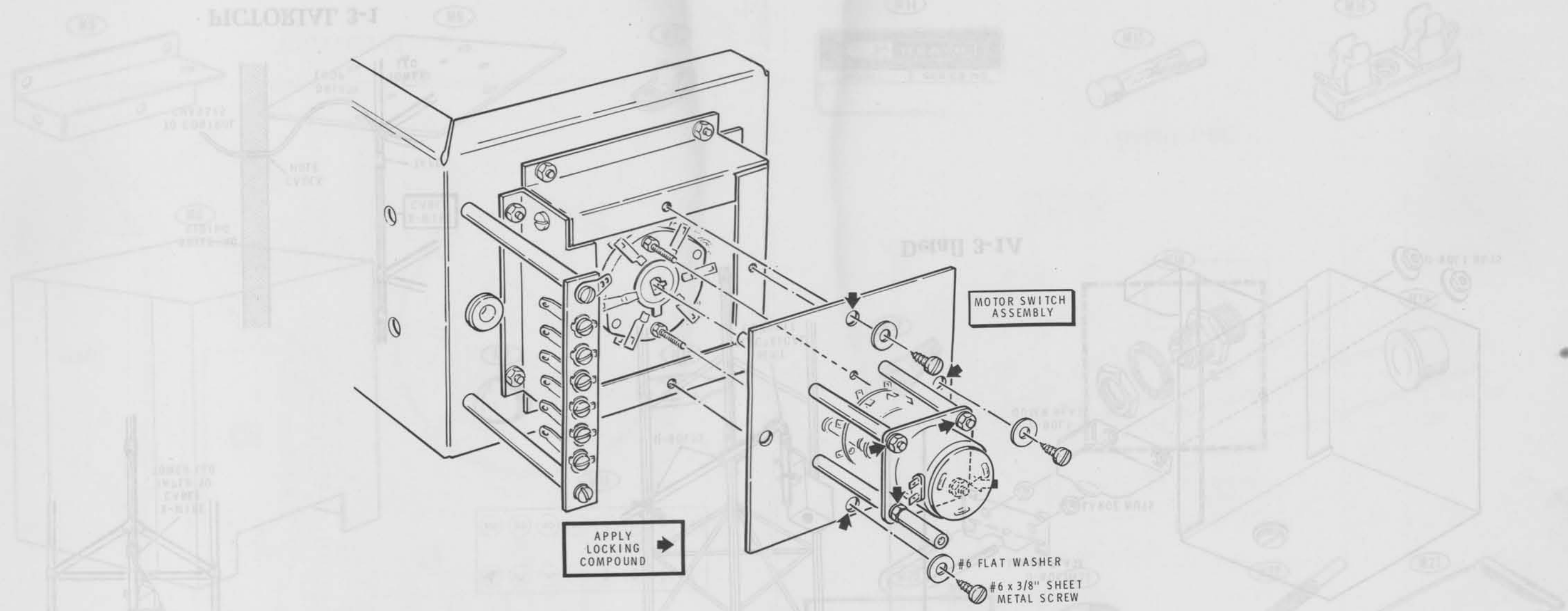

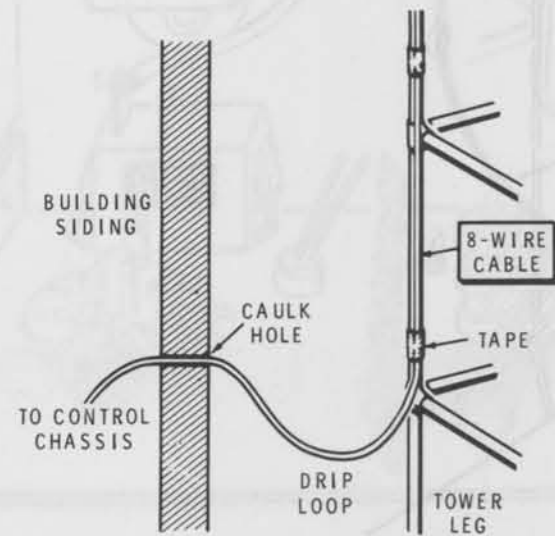
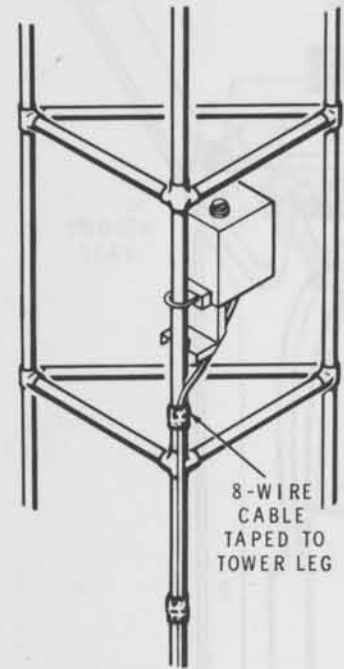

PICTORIAL 3-1

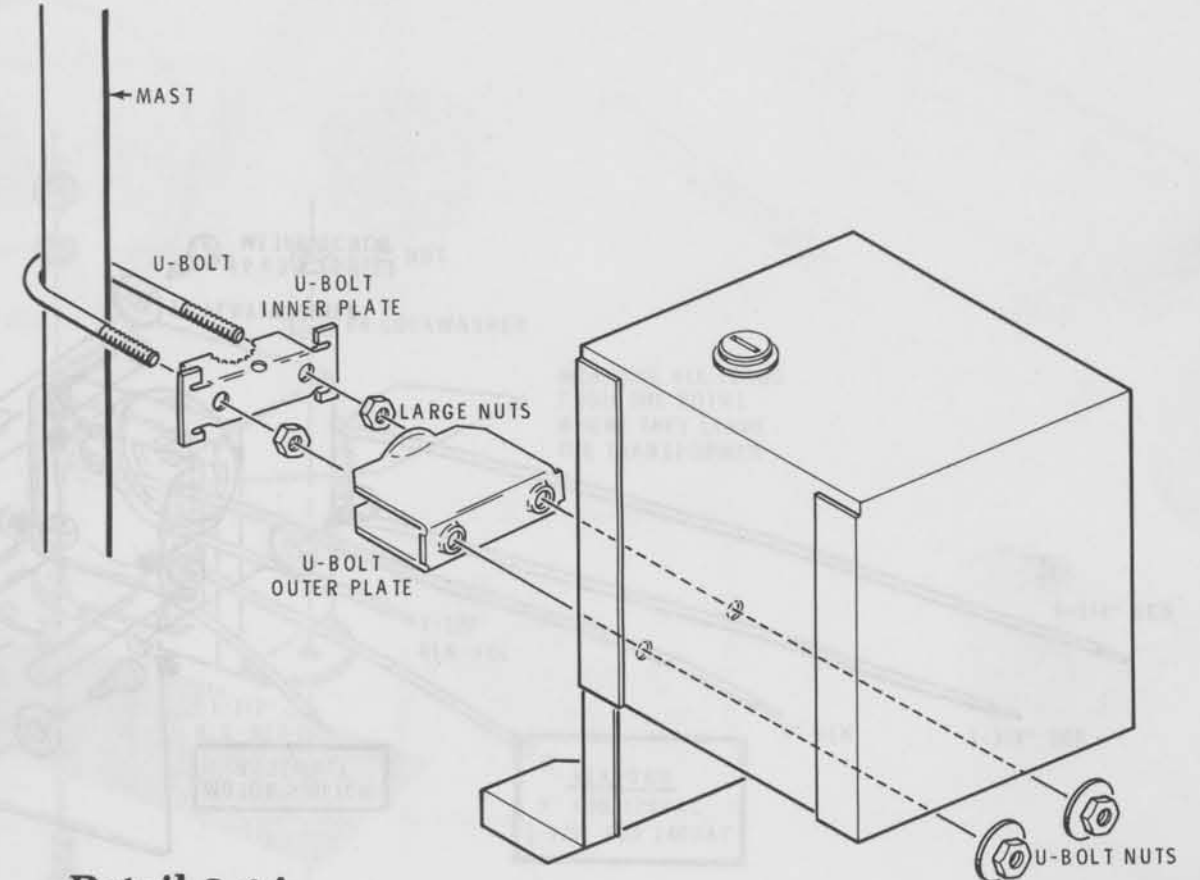
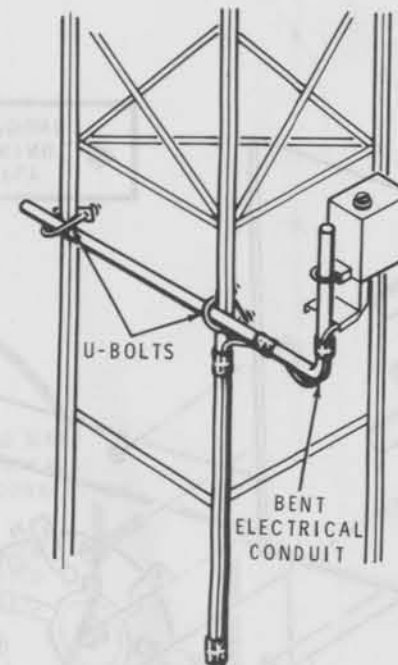

Detail 3-1A

Detail 1-8C

109091-01
P88 65-70

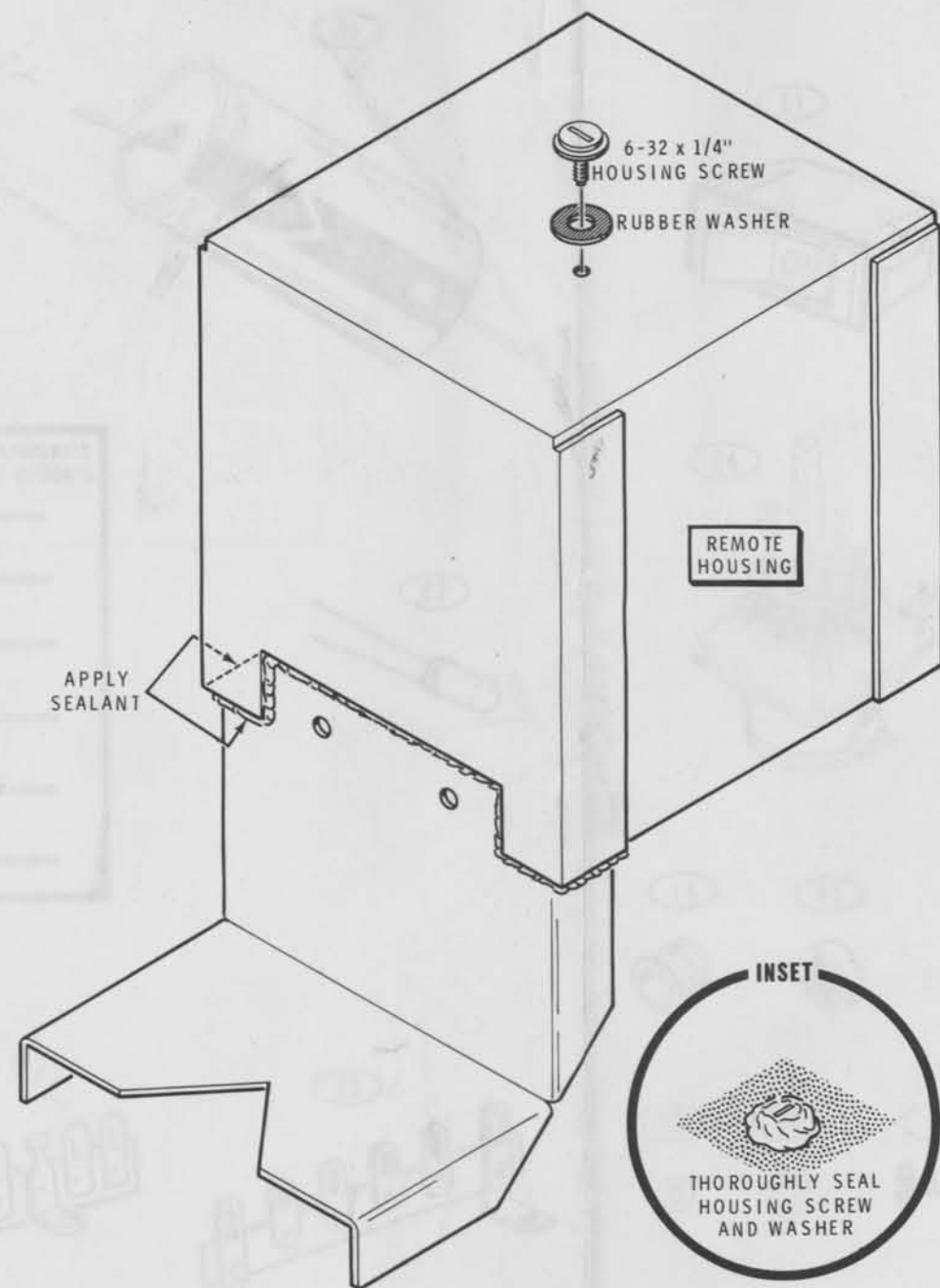

PICTORIAL 3-4